



# TS SERIES SCREW AIR COMPRESSOR

## SMART AIR POWER

**SWAN Screw Compressor TS Series** are equipped with high efficient Airend , robust electric motor, precise oil filter, modular air suction system , and friendly control panel, etc, to make the whole unit performance outstanding and remarkable.



POWERFUL  
Reliable



### Good levels of distinctive combination

With distinctive modular design and friendly operating system, our new developed TS series are able to provide reliable quality, quiet running mechanism and easy maintenance.

The adoption of Screw Air End is dependable on highly powerful performance.

### Powerful and quiet

High RIGID Structure with technological anti-noise and high efficient cooling system design to ensure silent running and long-term operation capability.

### Versatility and user's friendly

The machine is equipped with versatile module control, friendly operation monitor, remote multi-units control and overload protection device.....etc, which makes it easy to operate and do maintenance.

### Easy Maintenance

Easy to access to all related components make trouble-shooting and general maintenance easy and inexpensive.

### Reliability and durable transmission mechanism

Mounted with auto tension adjustable mechanism to keep always the best belt tension, which will result in quiet and smooth energy transmitting.

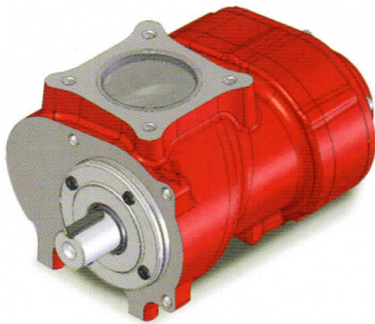

## LOW NOISE

The reliable Airend is with the most advanced Rotary design to reach high efficient, Low noise and Low vibration.

### The friendly control panel has the following features

1. Protective functions against motor short-circuit, seized, lose phase, overload, unbalance.. etc.
2. Protective function against motor reverse rotation.
3. Multi-points pressure and temperature monitoring and protective control.
4. Automatic control ON/OFF of the Cooling Fan.
5. Displaying the actual running condition through the screen.
6. with Remote control function.
7. With multi- units integrated function.
8. With RS-485 mutual telecommunication function.
9. Record and display historic Error messages. Can display the latest 5 sets of record.

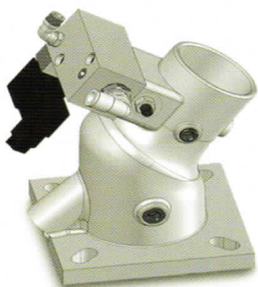

### Suction Regulator Valve

Features:

1. Very compact design, less pipings , less pressure loss, easy to do maintenance.
2. Use a single Solenoid Valve to execute air release and unloading running.
3. Reduce the noise - - During unloading running, the compressed air is flowing through the Suction Valve to reduce the noise.
4. Equipped with Check Valve to prevent oil spraying out when stop running suddenly.
5. Quick Air Release design to greatly reduce loading current and safe energy.



- A Friendly Control Panel
- B Reliable Electric Components For Control System
- C Oil Separator Element
- D Oil Recovery Tank

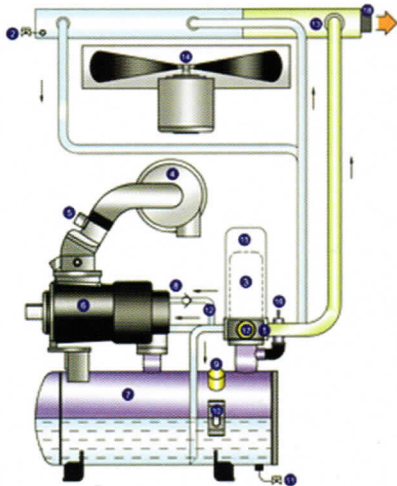

- 1 Multi-function valve Assembly
- 2 Oil drain valve (Oil cooler)
- 3 Oil filter
- 4 Suction
- 5 Suction Regulator
- 6 Air end
- 7 Oil Recovery Tank
- 8 Oil Check valve
- 9 Oil fill port
- 10 Oil level gauge
- 11 Oil drain valve (Oil reclaimer)
- 12 Oil recovery pipe
- 13 Oil / Air cooler
- 14 Cooling Fan and Motor
- 15 Oil Separator element
- 16 Safety valve
- 17 Minimum pressure check valve
- 18 Air outlet

Compressed Air  
Oil  
Air/Oil mixture

Cost Savings

High Efficiency

Small Noise Design

### Save Maintenance cost

The compact structure design makes routine maintenance and service simple and easy.

### High efficient power transmission system

Equipped with automatic belt tension adjusting mechanism to maintain the best power transmission between the motor and the Airend during running the Unit. Prolong the belt and bearings' service life and save the maintenance cost.

### Low vibration and low noise

Features:

1. Equipped with shock absorbers under the Base Frame to make smooth running, low vibration and low noise.
2. The sheet metal around the air-intake area is mounted with Noise Barrier and noise absorption material to effectively reduce the noise.
3. The precise Airend has been well dynamically balanced to guarantee low vibration.

# Specification

MODEL	TS-15	TS-22	TS-30	TS-37	TS-45	TS-55	TS-75
Power [ Kw ] & [ Hp ]	15 / 20	22 / 30	30 / 40	37 / 50	45 / 60	55 / 75	75 / 100
Pressure [ Kg/Cm <sup>2</sup> ]	7 / 10 / 13	7 / 10 / 13	7 / 10 / 13	7 / 10 / 13	7 / 10 / 13	7 / 10 / 13	7 / 10 / 13
F.A.D [ m <sup>3</sup> /min ]	2.4/1.9/1.6	3.5 / 2.85 / 2.4	5 / 4.2 / 3.3	6/5/4.2	7.2/6.2/5.3	9.3/7.8/6.6	12/11/10
Voltage & Frequency [Hz]	50						
Cooling Method	Air-Cooled						
Drive System	Belt-drive						
Air Delivery Connection	1"	1"	1"	1 ¼ "	1 ½ "	2"	2"
Dimension LxWxH [ mm ]	780x950x1100	780x950x1100	950x1020x1250	920x1100x1350	1200x1200x1650	1700x1400x1650	1700x1400x1650
Weight [ Kg ]	400	410	520	600	850	1350	1450
Discharge Temperature	Environmental Temp +13 °C						



ISO 9001 : 2008

Since 1956

[www.swan-compressors.com](http://www.swan-compressors.com)

## PT. ANGSA PUTIH KURNIA KHARISMA

Member of SWAN Compressor Group

Head Office

Jl. Kartini Raya No. 25A, Jakarta Pusat 10750 Indonesia

Telp. : (62-21) 6230 9677, 6230 9678 (Hunting)  
(62-21) 384 9612, 344 7965

Fax. : (62-21) 384 9609, 344 7969, 351 0291

Email. : [marketing@swan-compressors.com](mailto:marketing@swan-compressors.com)

Home Page. : <http://www.swan-compressors.com>

Work Shop. : Jl. Jurumudi Kebon Besar, Tangerang

Spare Part. : (62-21) 6230 9677 Fax. : (62-21) 628 0002

Service Center. : (62-21) 553 9199 Fax. : (62-21) 553 9206

Branch

Tangerang : (62-21) 5565 2914 Fax. : (62-21) 5565 2915

Cikarang : (62-21) 8984 2356 Fax. : (62-21) 8984 2357

Surabaya : (62-31) 841 7744 Fax. : (62-31) 841 6443

Semarang : (62-24) 7663 3277 Fax. : (62-24) 7663 3276

Bandung : (62-22) 604 7213 Fax. : (62-22) 604 7213

Medan : (62-61) 8050 8091 Fax. : (62-61) 8050 8091